

30 Vallance Close, Burgess Hill, West Sussex, RH15 8TY

£1,150 Per Calendar Month

PSPhomes

www.psphomes.co.uk

A delightful one bedroom terraced house located in a very popular residential close within highly regarded West End Meadows. Offered unfurnished and late April. EPC Rating "D "

The House

The well proportioned accommodation comprises living room, modern kitchen, a large double bedroom and a modern bathroom.

Outside the property provides an enclosed rear garden with shed, front garden and two allocated parking spaces

Further attributes include replacement double glazing.

The Location

Vallance Close is located on the western outskirts of Burgess Hill and the property is very conveniently located to take advantage of highly regarded primary and senior schools. The Triangle Leisure Centre and A23 are easy to access. Both of the town's mainline stations are within two and a half miles whilst the town centre.

Information

Council Tax Band "B" £1,832.50 for 2025/2026

Permitted Fees:

Holding deposit - one weeks rent £265.38

Deposit - five weeks rent £1,326.92

The holding deposit will be refunded against the first month's rent but can be retained if the applicant withdraws from the property, fails the reference checks due to false or misleading information or fails the Right to Rent checks.

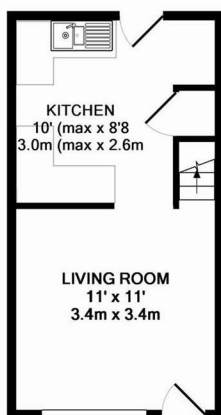
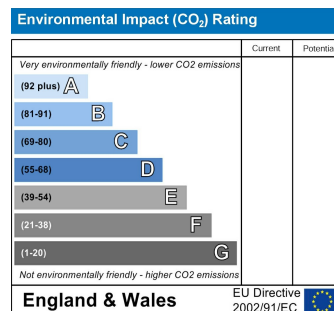
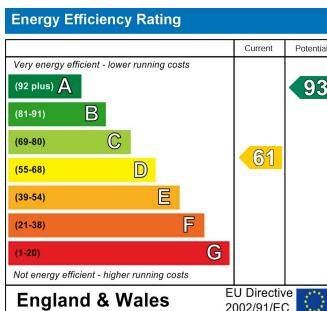

GROUND FLOOR
APPROX. FLOOR
AREA 231 SQ.FT.
(21.5 SQ.M.)

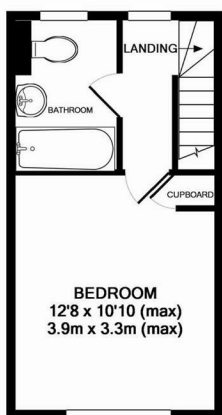

1ST FLOOR
APPROX. FLOOR
AREA 228 SQ.FT.
(21.2 SQ.M.)

TOTAL APPROX. FLOOR AREA 459 SQ.FT. (42.7 SQ.M.)

Plans for illustration purposes only. Intending purchasers should check measurements personally.
Made with Metropix ©2014

PSPhomes

VIEWING BY APPOINTMENT WITH PSP HOMES

54 Church Road, Burgess Hill, West Sussex, RH15 9AE. TELEPHONE 01444 250999
www.psphomes.co.uk

Much care is taken in the preparation of our particulars, but we cannot guarantee that the information given is accurate.
Property details are issued as a general guide only and may not form any part of an offer or contract. We recommend that intending purchasers check details personally.